



# wonderwalls

hanging your wonderwall

Congratulations! You're about to transform your room into something really special with the help of your wonderwall mural.

Your mural has been pre-cut into wallpaper 'drops' of equal width and length. These instructions are designed to help you hang your wonderwall quickly and easily. Read them carefully before you make a start.

**If you are at all unsure about hanging the paper, please consult a professional decorator. Wonderwalls cannot take responsibility for any damage caused to your mural after it has been delivered or during hanging.**

## What you will need

tape measure	stanley or wallpaper knife
spirit level	plumb line
pencil	wallpaper paste
pasting table	paint brush
wallpaper brush	sponge

### Before you start!

Ensure you have a clean, smooth surface on which to hang your wallpaper. If your wall has been recently plastered you should ensure the plaster is perfectly dry and size the wall first to seal the plaster. This can be done with sizing paste available from any good DIY store. If the wall is particularly uneven you may wish to hang a lining paper before you apply your wonderwall.

### How to apply your wallpaper

1. First, organise your wallpaper drops in the order you will need to apply them – going from left to right of your illustration. You will find all of the drops have some 'bleed' – additional paper to allow for trimming - at the top, bottom and along one vertical edge of the first and last drops.

2. Measure the width of the second wallpaper drop (since the first drop has extra paper for trimming). Use this measurement to

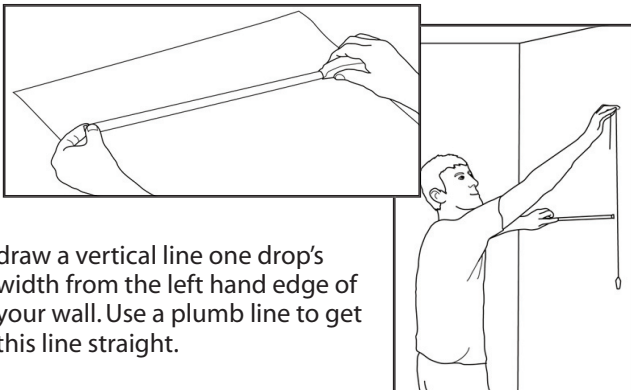

draw a vertical line one drop's width from the left hand edge of your wall. Use a plumb line to get this line straight.



3. wallpaper drop. Align the right hand edge of the first drop with the line you have just drawn and use your wallpaper brush to smooth the wallpaper into the edges and corners of your wall.

3. Your wonderwall is designed to be hung using standard wallpaper paste. If you are new to wallpaper hanging we recommend that you use a commercially available pre mixed paste. If you are happy to use a dry mix paste, make up the wallpaper paste according to the manufacturer's instructions. Apply paste to the first

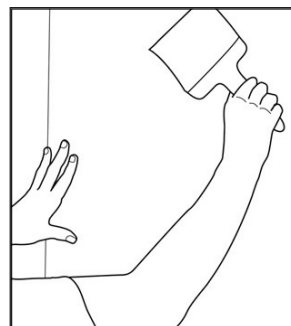
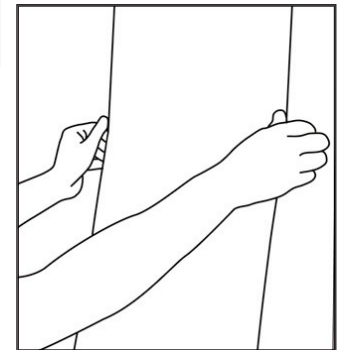

4. Once your first drop is correctly in place you can begin to apply each of the remaining drops so that the edges abut one another and align accurately to create your illustration. Smooth out any ripples or bubbles as you go with your wallpaper brush and wipe off any excess paste with a damp sponge.

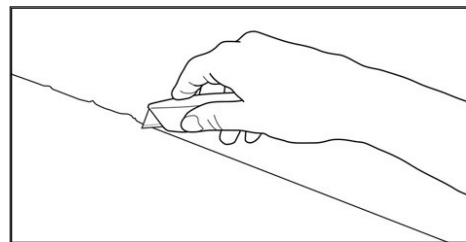

5. When you are certain that your wallpaper drops are straight and accurately aligned, trim off the bleed from the top,

sides and bottom, with your wallpaper knife. You may find it easier to wait for two or three hours before trimming your wall to allow the wallpaper to dry, making cutting

6. Step back and admire your wonderwall! Like any wallpaper you may notice some small bumps and ripples. This is perfectly normal and these will disappear as the paper dries.

Wonderwalls. Studio 5, Carpenters Buildings, Carpenters Lane, Cirencester, Gloucestershire, GL7 1EE.